

Geberit AquaClean Sela

■ GEBERIT



User manual

Table of Contents

Safety	2
Product description	3
Operation	5
Maintenance	12
Sustainability	18
Conformity	19

Safety

Target group

This document is intended for all users of the Geberit AquaClean Sela.

Intended use



The Geberit AquaClean Sela is a toilet which is designed for cleaning the anal area. Its use for any other purpose is deemed improper. Geberit accepts no liability for the consequences of improper use.

Safety notes

- In the event of evidence of damage to the Geberit AquaClean Sela, disconnect the unit from the mains immediately and contact Geberit Customer Service
- If the mains connection cable is damaged, it must be replaced by a skilled person
- Never open and repair the Geberit AquaClean Sela yourself. Do not modify the unit or add any additional modules. The Geberit AquaClean Sela contains live parts. Opening the unit exposes those present to fatal danger
- Repairs may only be carried out by trained and authorised skilled persons using original spare parts and accessories
- The Geberit AquaClean Sela must only be connected to an earthed mains voltage conforming to the specification plate. For more technical data, see "Technical data"
- The Geberit AquaClean Sela may be used by children aged 8 years and up as well as persons with reduced physical, sensory or mental capabilities or a lack of experience with and knowledge about the device, provided that they are supervised or taught how to use the device safely and that they understand the hazards that may result from this. Children must not play with the device. Children must not carry out cleaning or maintenance work without supervision.
- Operation and maintenance work may only be performed by the operator or user as described in these operating instructions
- The Geberit AquaClean Sela may only be operated with potable water

Explanation of symbols

Table 1: Symbols in the instructions

Symbol	Meaning
DANGER 	Refers to an immediately dangerous situation that may cause serious injury or death.
	Refers to important information.
	Indicates that a visual check must be carried out.

Product description

System description

Essentially, the Geberit AquaClean does not differ from a conventional toilet. You do your business as you usually would. The difference is in what you do next. Geberit AquaClean cleans you gently and thoroughly with water whereas, with a conventional WC, you clean your bottom with toilet paper. Cleaning with water is more thorough and gentler on the skin and improves the general well-being. For everyone who attaches great importance to well-being, cleanliness and freshness.

Function

While you are sitting, a jet of water at body temperature cleans you with just the right intensity at the push of a button. Additional functions, a remote control and comfortable sitting round off the shower concept. Operation is effortless. Either press the clearly labelled buttons on the side of the unit or use the supplied remote control.

Technical data

Nominal voltage	220–240 V AC
Mains frequency	50 / 60 Hz
Power consumption	750–900 W
Power consumption economy mode / with heating element switched on	0.45 / 5.8 W
Protection degree	IPX4
Protection class	I
Mains connection	Direct connection via system plug with flexible 3-wire plastic-sheathed cable
Flow rate, anal shower	0.9–1.5 l/min
Spray time factory setting	20 s
Storage water heater capacity	1.2 l
Number of shower pressure settings, shower spray	5
Water temperature factory setting	37 °C
Operating temperature	10–40 °C
Storage temperature	–10 – +60 °C
Flow pressure range	0.05–1 MPa 0.5–10 bar
Maximum load WC seat / WC lid	150 kg

Changes

These operating instructions correspond to the device's state of the technology at the time of printing. Geberit reserves the right to make changes in terms of further development.

Operation

Overview of controls

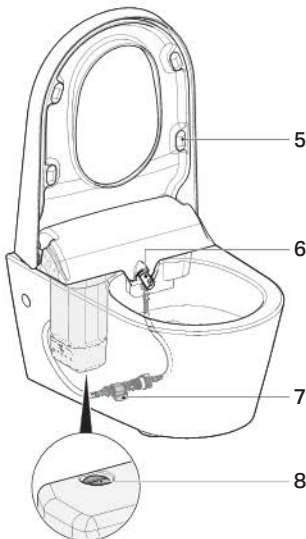

- 1 Specification plate and serial number (rear)
- 2 Control panel
- 3 Cleaning instructions for end users
- 4 Power switch under cover
- 5 Compensation pad
- 6 Spray arm with spray nozzle
- 7 Ball valve for water supply
- 8 Drain screw for water tank

Control panel

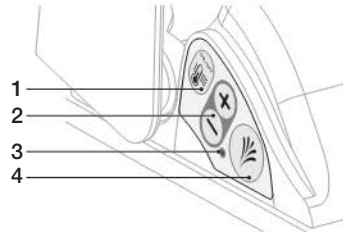

- 1 Water heater function button: ON/OFF/economy mode
- 2 <-> / <+> buttons: Decrease or increase spray intensity
- 3 Water heater function LED display
- 4 Shower button: Start and stop shower

LED display

LED	Meaning
Lights up blue	Heating element is switched on
Flashes blue	Switching to economy mode. In economy mode (factory setting), the heating element only switches on if user detection is activated. The warm-up time is 2 to 3 min
Does not light up	Heating element is switched off or economy mode is switched on and user detection is not activated
Flashes red	Malfunction message (see "Malfunctions during operation")

Remote control

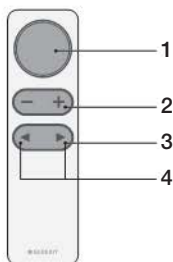

- 1 Shower button: Start and stop shower
- 2 <-> / <+> buttons: Decrease or increase spray intensity
- 3 Arrow keys: Spray arm position forwards and backwards
- 4 Arrow keys (simultaneously): Oscillating spray on and off

Using Geberit AquaClean Sela

The device includes a user detection function. When you sit down on the WC seat, the Geberit AquaClean Sela and the remote control are activated.

- i** You start the toilet flush as usual by pressing the flush plate on the cistern. The Geberit AquaClean Sela can be used as a normal toilet at any time.

Switching the Geberit AquaClean Sela on and off

- 1** Using a screwdriver, open the cover on the right-hand side.

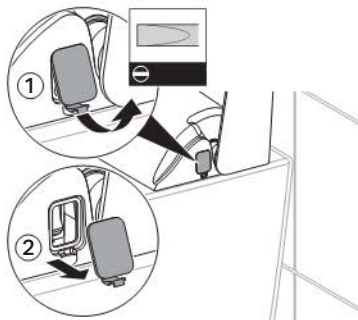

- 2** Switch the power switch on or off, respectively.

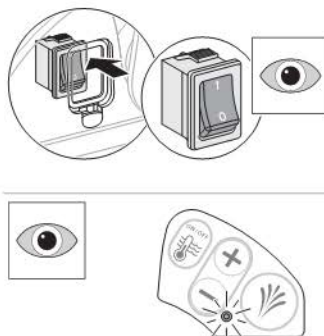

Result

After switching on, the LED on the control panel flashes blue three times and then stays lit for 10 min after the last user detection.

Switching on the shower

i The spray nozzle is automatically cleaned with water before and after each shower procedure.

- 1** Sit down on the toilet.
- 2** Press the shower button on the control panel or on the remote control.

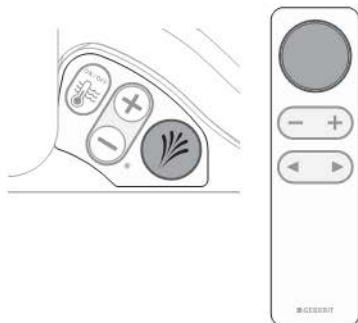

Result

The shower starts and stops after 20 s. You can interrupt the shower procedure before this by pressing the shower button.

Adjusting the spray intensity

i You can set the spray intensity in five stages. The last set spray intensity is saved.

- ▶ During the shower procedure, press the button <-> or <+> on the control panel or on the remote control.



Result

The shower spray gets stronger or weaker, respectively.

Adjusting the spray arm position

i You can set the spray arm position in five stages. The last set spray arm position is saved.

- ▶ During the shower procedure, press the arrow keys on the remote control.



Result

The spray arm moves forward or backward, respectively.

Switching the oscillating spray on and off

The oscillating spray increases the cleaning effect through forward and backward motions of the spray arm.

- ▶ Press both arrow keys simultaneously on the remote control.



Result

The spray arm moves back and forth.

Switching the storage water heater on and off

- ▶ Press the button <water heater function> repeatedly until the LED on the control panel shows the desired status (ON/OFF/economy mode).



Result

The LED on the control panel indicates whether the storage water heater is switched on or off or whether it is set to user detection (economy mode) (see "Control panel").

WC seat and lid with lowering function

Dampers cushion the WC seat and lid noiselessly and slow down closing. The seat and lid open just like any normal WC seat and lid.

- i** Do not press the WC seat and lid down with your hand. This will damage the dampers.

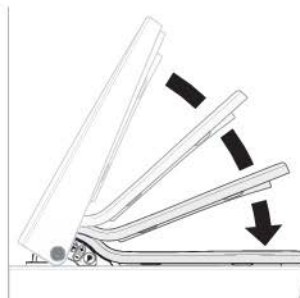

Emptying the storage water heater

- i** If you are not going to use the Geberit AquaClean Sela for a long period of time (e.g., during a holiday), we recommend that you empty the storage water heater. As soon as you put the Geberit AquaClean Sela back into operation, the storage water heater fills with water automatically.

- 1** Close the ball valve.

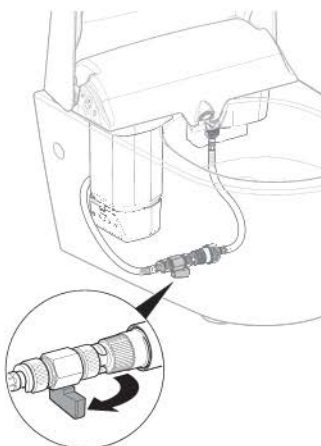

- 2** Switch off the device at the power switch.

- 3** Place a suitable receptacle with at least 1.3 l filling volume underneath the drain screw.

- 4** Use a coin to open the drain screw by a quarter of a turn.



Result

The water from the storage water heater drains into the receptacle.

- 5** Use a coin to close the drain screw by a quarter of a turn.

Malfunctions during operation

**DANGER****Danger of fatal electric shock**

- ▶ Never open and repair the device yourself.
- ▶ Never replace damaged mains connection cables yourself.
- ▶ Contact customer service.

Malfunction	Cause	Fault clearance
No function	Mains plug is not connected to power outlet	▶ Connect the mains plug
	Defective fuse on electrical distributor	▶ Replace fuse on electrical distributor
	Fuse in mains connection cable is defective	▶ Disconnect the mains plug and contact customer service
	Power supply is interrupted	▶ Have the power supply checked by a skilled person
Shower water temperature is too low	Heating element is not switched on	▶ Press <water heater function> button
Shower spray is too weak or no water is spraying out at all	Spray intensity is set too low	▶ Increase spray intensity
	Spray nozzle clogged or blocked with limescale	▶ Clean or replace the spray nozzle
	Basket filter is clogged or blocked with limescale	▶ Clean or replace the basket filter
Spray arm does not retract	Power supply is interrupted	▶ Restore the power supply. The spray arm will retract automatically
	Shower toilet is defective	▶ Switch off the toilet and contact customer service
Lowering function not working	Hydraulics are defective	▶ Contact customer service
Water runs out of the overflow on the left next to the spray arm		▶ Disconnect the mains plug, close the ball valve, and contact customer service
WC seat rocks	Compensation pads are missing	▶ Mount new compensation pads
	"Standard" compensation pads are mounted	▶ Replace "standard" compensation pads with "elevated" compensation pads
Remote control not working	Battery of the remote control is dead	▶ Replace battery





Malfunction	Cause	Fault clearance
LED flashes red: once every 2 s	Temperature sensor is defective	▶ Contact customer service
LED flashes red: twice every 2 s	Ball valve is closed	▶ Open ball valve
	Basket filter is clogged or blocked with limescale	▶ Clean or replace the basket filter
LED flashes red: three times every 2 s	Spray arm is blocked	▶ Check the opening of the spray arm ▶ Check the nozzle position, push the nozzle on correctly ▶ Contact customer service
LED flashes red: four times every 2 s	Water is warmer than 45 °C. Thermal cut-out has tripped	▶ Contact customer service
LED flashes red: five times every 2 s	Water pump no longer working properly or defective	▶ Contact customer service

Maintenance

Permissible cleaning agents and cleaning equipment

Cleaning agents	
	Cleaning agents are permitted to have a low acid content, e.g. they may contain citric acid
	Cleaning agents should ideally be diluted with water
	Cleaning agents must be fluid
	Cleaning agents must be dermatologically tested
	The use of foaming cleaning agents is permitted
Cleaning equipment	
	Sponge, eraser
	Cloth, shammy leather
	Toilet brush

Non-permissible cleaning agents and cleaning equipment

Cleaning agents	
	The use of powdery cleaning agents, such as scouring powder or scouring agent, is not permitted
	The use of corrosive cleaning agents, such as concentrated drain cleaners, is not permitted
	The use of cleaning agents which may irritate the eyes or the skin is not permitted
	The use of cleaning agents with a high chlorine concentration is not permitted
	The use of abrasive cleaning agents, such as sand or scouring liquid, is not permitted
Cleaning equipment	
	Scratching sponge
	Steel wool, steel cleaner, scrubbing sponge

Tips

Problem	Fault clearance
Spray nozzle blocked with limescale or clogged by foreign bodies in the water	To clean the spray nozzle, submerge it in standard limescale remover for a few hours
Urine scale deposits on the WC ceramic appliance	To clean, apply a mild bathroom cleaner ($4 \leq \text{pH value} \leq 9$) and leave to work for 30 min, then rinse with water. Cleaning gels and foam cleaners are particularly good for this type of cleaning, as they stick to sloping surfaces
Rusty water residues on the WC ceramic appliance	Will not damage the coating on the WC ceramic appliance. To clean, apply a mild bathroom cleaner ($4 \leq \text{pH value} \leq 9$) and leave to work for 30 min, then rinse with water
Limescale residues on the WC ceramic appliance	To clean, apply a mild bathroom cleaner ($4 \leq \text{pH value} \leq 9$) and leave to work for 30 min, then rinse with water

Care and cleaning

The Geberit AquaClean Sela is a high-quality, easy-care product.

The WC ceramic appliance has a special coating. This coating draws water drops together to form spheres which drip away very effectively. Residue such as limescale and dirt is taken up by the water drops and simply flushed away with them. This effect is very environmentally friendly, as aggressive WC cleaning agents are no longer required. The WC seat and lid are easy to clean and, if necessary, to remove. Similarly, the spray nozzle can easily be replaced if it becomes blocked with limescale or clogged with dirt.



Aggressive cleaning agents can damage the material surface. Therefore, we ask that you follow the care and cleaning instructions below.

Cleaning the WC ceramic appliance

Prerequisites

When cleaning the WC ceramic appliance, always lift up the WC seat and WC lid. Any vapours rising off cleaning agents can corrode the surface.

i Do not use scratching sponges or abrasive scouring agents for cleaning.

- 1** Clean the WC ceramic appliance with a mild bathroom cleaner or a mild all-purpose cleaner.
- 2** Rinse the WC ceramic appliance with water.
- 3** Use a toilet brush to remove stubborn stains and rinse with water.

Cleaning the WC seat, WC lid and housing

i Do not use scratching sponges or scouring agents for cleaning. We also advise against the use of cleaners containing solvent or acid, limescale removers, vinegar and cleaning agents containing acetic acid. They corrode the surface and can lead to discolouration.

- 1** Wipe the WC seat, WC lid and housing with a soft cloth and a mild washing-up liquid that is kind to the skin.
- 2** Dry the WC seat, WC lid and housing with a soft cloth.

Removing the WC seat and WC lid for cleaning

i The WC seat and lid can be removed, cleaned and remounted quickly and easily when heavily soiled.

- 1** Lift up the WC seat and WC lid.
- 2** Remove the WC seat and WC lid by vertically lifting them out of the bracket.

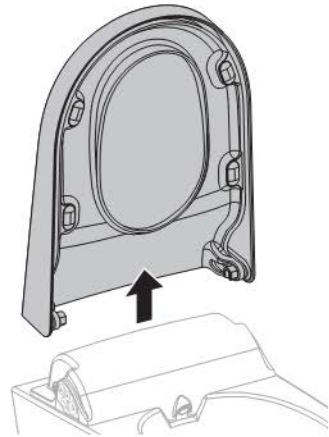

- 3** Clean WC seat and WC lid.
- 4** Insert the WC seat and WC lid vertically from the top into the bracket.
- 5** Let the WC seat and WC lid glide down.

Cleaning or replacing the spray nozzle

- 1** Lift up the WC seat and WC lid.
- 2** Simultaneously press the buttons \leftarrow and \rightarrow or the button \leftarrow and the shower button.



Result

The spray arm extends without spraying any water.

- 3** Hold the spray arm in place with one hand and carefully pull off the spray nozzle with the other hand.

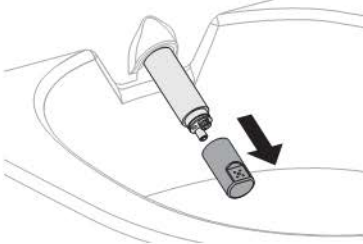

i If the spray nozzle is soiled so heavily that it cannot be cleaned, the spray nozzle must be replaced.

- 4** Clean and descale the spray nozzle.
- 5** Simultaneously press the buttons \leftarrow and \rightarrow or the button \leftarrow and the shower button.

Result

The spray arm returns to its starting position.

- 6** Clean the spray arm opening.

- 7** Simultaneously press the buttons \leftarrow and \rightarrow and \leftarrow and \rightarrow or the button \leftarrow and the shower button.

Result

The spray arm extends without spraying any water.

- 8** Push the cleaned or a new spray nozzle onto the spray arm.

- 9** Simultaneously press the buttons \leftarrow and \rightarrow or the button \leftarrow and the shower button.

Result

The spray arm returns to its starting position.

Cleaning or replacing the basket filter

- 1** Close the ball valve underneath the WC ceramic appliance.

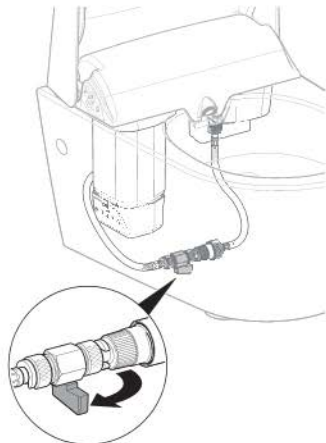

- 2** Remove the reinforced braided hose and drain the residual water into a receptacle.

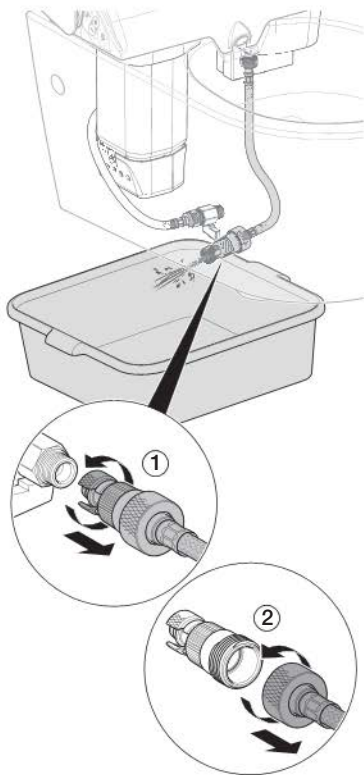

- 3** Remove the basket filter.



i If the basket filter is soiled so heavily that it cannot be cleaned, the basket filter must be replaced.

- 4** Clean and descale the basket filter.

- 5** Insert the cleaned or a new basket filter.

- 6** Screw on the reinforced braided hose.

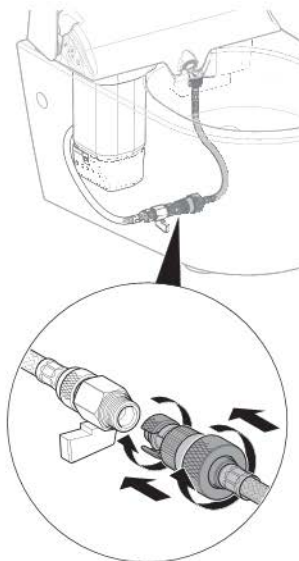

- 7** Open the ball valve underneath the WC ceramic appliance.

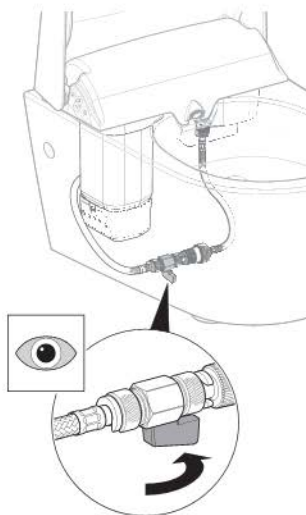

Replacing the compensation pad

i The Geberit AquaClean Sela can be damaged if the compensation pads do not lie evenly on the WC ceramic appliance.

- 1** Lift up the WC seat and WC lid.
- 2** Remove the damaged compensation pad.

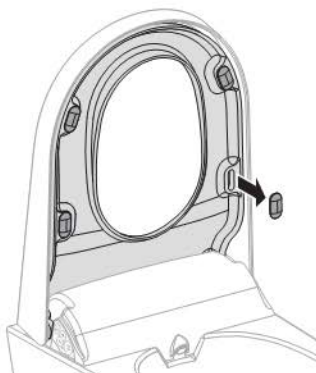

- 3** Insert a suitable compensation pad.



Replacing the remote control battery

i Stand next to the shower toilet so that the remote control is detected.

- 1** Open the compartment on the rear of the remote control.
- 2** Replace the battery, type CR2032. Dispose of the dead battery appropriately.

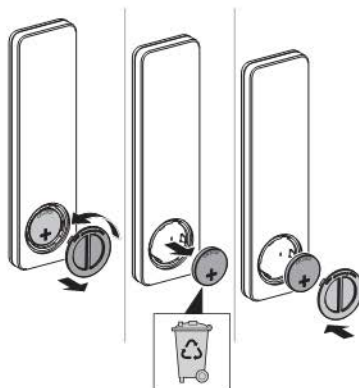

- 3** Close the compartment on the rear of the remote control.

Geberit and sustainability

As the European market leader in the sanitary industry, Geberit stands for water saving, resource efficiency and sustainable building. The Group has proven for decades that long-term business success is compatible with environmentally friendly actions and social policies. A company management geared to sustainability helps to save costs while minimizing risks at the same time. Geberit aims to act as a role model and set standards for its customers, suppliers and other partners. This means creating water-saving and sustainable products, using safe, environmentally friendly and resource-efficient production practices, engaging in purchasing and logistics activities with high environmental and ethical standards, and offering excellent working conditions for more than 6,000 dedicated and highly qualified employees worldwide. One way in which the company is showing its awareness of social responsibility is by participating in water relief projects around the world.

Ecodesign – ecobalance

The basis for sustainable products is formed by a systematic innovation process in which product materials and functional principles are chosen that are as environmentally friendly as possible, risks are minimized and a high degree of resource efficiency is strived for. We can supply a detailed ecobalance for this product upon request.

Tips for reducing the ecological footprint

This product was developed with the utmost care, also with regard to the consumption of energy, water and resources (see also technical data). You can reduce the ecological footprint of the product by

- switching off the device when you go on holiday
- manually interrupting the spray functionality and thus saving hot water
- using as little paper as possible for drying
- switching off the water heater function (OFF)
- using environmentally friendly cleaning agents
- servicing the device regularly and handling it with care
- returning the device to Geberit or a designated partner for appropriate disposal

Materials

This product conforms to the requirements of the EU directive "Restriction of the use of certain hazardous substances" (RoHS, 2011/65/EU) and is free from environmental pollutants such as lead, mercury, cadmium and chrome VI.

The European chemical regulation REACH (1907/2006/EC), which regulates the registration, assessment, approval and restriction of certain chemical substances, is also complied with.

Disposal of old electrical and electronic equipment



In accordance with Directive 2002/96/EC WEEE on waste electrical and electronic equipment, manufacturers of electrical equipment are obliged to take back old equipment and to dispose of it correctly.

The symbol indicates that the product cannot be disposed of with non-recyclable waste. Old equipment should be returned directly to Geberit, where it will be disposed of appropriately. Please contact your responsible Geberit sales company or visit www.geberit.com for addresses to which equipment can be returned.

Conformity

Declaration of conformity

You can obtain a copy of the declaration of conformity from your responsible Geberit sales company.

**Geberit Sales Ltd.
Geberit House
Academy Drive
Warwick
Warwickshire CV34 6QZ**

**T (0)1926 516 800
T (0)1926 516 809
In Eire T +44 1622 717 811**

→ www.i-love-water.co.uk

**Geberit International Sales AG
Dubai Branch
P.O. Box 54715,
Dubai Airport Free Zone
East Wing, Bldg- 4A, 4th Floor, 401,
Dubai - UAE**

**T +971 4 204 5477
F +971 4 204 5497**

→ www.geberit.ae

**Geberit Southern Africa (Pty.) Ltd.
17-15 Street, Eastgate Gardens
Commercial Park
Sandton, South Africa**

**T +27 11 444 5070
F +27 11 444 5992**

→ www.geberit.co.za