

■ GEBERIT



GEBERIT AQUACLEAN MERA CLASSIC

HOUSEKEEPER AND CLEANING GUIDE

The device at a glance

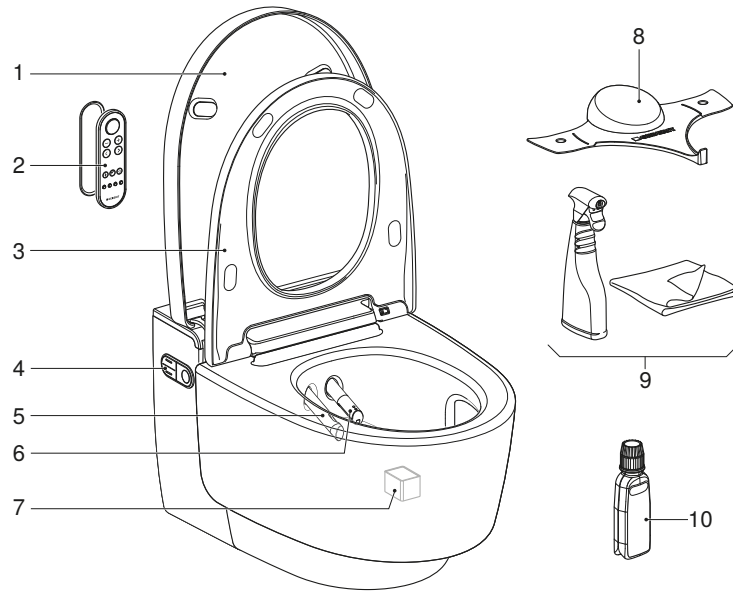

- 1 WC lid
- 2 Remote control with magnetic wall-mounted holder
- 3 WC seat ring with user recognition and QuickRelease function
- 4 Lateral control panel with status LED
- 5 Dryer arm with dryer nozzle
- 6 Spray arm with spray nozzle and Lady shower nozzle
- 7 Ceramic honeycomb filter (art. no. 242.999.00.1)
- 8 Spray shield
- 9 Geberit AquaClean cleaning set (art. no. 242.547.00.1)
- 10 Geberit AquaClean descaling agent (art. no. 147.040.00.1)

Status LED on the lateral control panel

The status LED on the lateral control panel informs you of the current device status. The current condition of the device is therefore visible.

Status LED	Description
Does not light up	Heating element is switched off/economy mode is active.
Lights up blue	The heating element is switched on.
Flashes blue	The device initialises after switching on.
Lights up green	The ceramic honeycomb filter must be replaced. → See "Replacing the ceramic honeycomb filter", page 45.
Flashes red	A malfunction message is pending. ▶ If [Error message] is displayed on the remote control: contact customer service.
Flashes blue-red	The device must be descaled. → See "Descaling the device", page 37.
Lights up orange	The device is now descaling. It is not possible to use the shower toilet for the duration of the descaling procedure.
Flashes orange	Water replacement is being carried out. → See "Automatic water replacement", page 32.

Geberit AquaClean app

The following shower toilet functions can be executed via the Geberit AquaClean app:

- Remotely controlling the Geberit AquaClean shower toilet.
- Displaying and adjusting the settings.

The Geberit AquaClean app offers the following additional benefits:

- Saving your personal settings on your smartphone.
- Support for care and maintenance of the device.
- Easy registration of your Geberit AquaClean shower toilet.
- Availability of user manuals.
- Availability of functionality videos.
- Availability of service and contact information.

The Geberit AquaClean app is available free of charge for Android and iOS smartphones in the respective App Store.

Android:



iOS:



i The range of functions offered by the Geberit AquaClean app may vary from country to country.

Cleaning and descaling the device

General cleaning recommendations

Cleaning the shower toilet at the recommended cleaning intervals will ensure that it functions properly. The shower toilet must only be cleaned using suitable cleaning agents and cleaning equipment. → See "Suitable cleaning agents and cleaning equipment", page 30.

Cleaning interval	Cleaning activity
Daily	<ul style="list-style-type: none"> ▶ Remove water drops with a soft, lint-free cloth to avoid limescale stains.
Weekly	<ul style="list-style-type: none"> ▶ Clean all surfaces and corners thoroughly. → See "Cleaning the WC lid and housing", page 34. ▶ Test spray nozzle and clean if required. → See "Cleaning the dryer arm and spray nozzle", page 35. ▶ Rinse the spray nozzle under running water to remove foreign substances.
Monthly	<ul style="list-style-type: none"> ▶ Clean the WC ceramic appliance with Geberit AquaClean cleaning agent. → See "Cleaning the flushing area of the WC ceramic appliance", page 33.

Suitable cleaning agents and cleaning equipment

ATTENTION

Aggressive descaling agents

Inappropriate descaling agents can damage the device.

- ▶ Only use Geberit AquaClean descaling agent for descaling.

ATTENTION





Aggressive and scouring cleaning agents



Cleaning using aggressive and scouring cleaning agents can cause surface damage.

- ▶ Use Geberit AquaClean cleaning agents.

Using the Geberit AquaClean cleaning set is recommended, as this set includes a ready-made cleaning agent that is ideal for cleaning all Geberit AquaClean surfaces.

Recommended properties of suitable cleaning agents and cleaning equipment for best cleaning results:

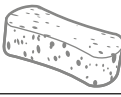
Symbol	Properties of suitable cleaning agents
	Skin-friendly
	Cleaning agents are permitted to have a low acid content, e.g. heavily diluted citric acid
	Low-foaming
	Liquid
	Water-dilutable

Symbol	Suitable cleaning equipment
	Soft, fine-pored sponges
	Lint-free, soft cloths which are free of dust
	Toilet brush

Automatic water replacement

If the shower toilet has not been used for more than 2 months, the device is rinsed with fresh water after it is switched on. This ensures optimum shower water quality before usage.

Targeted disinfection

Disinfection is only required if there is a definite risk of infection as a result of germs. Otherwise, keep to the recommended cleaning intervals and carry out the specified cleaning activities. → See "General cleaning recommendations", page 30.

ATTENTION

Aggressive disinfectants

Disinfection using aggressive disinfectants can cause surface damage.

- ▶ Only use alcohol-based disinfectants that are also suitable for hand and skin disinfection.
- ▶ Observe the safety notes from the manufacturer when handling hazardous substances.

Type of disinfection	Disinfection procedure
Wet wipe disinfection For use on smooth surfaces that can be rubbed	<ul style="list-style-type: none"> ▶ Moisten all surfaces with disinfectant. ▶ Allow the disinfectant to take effect according to the manufacturer information. ▶ Then rub the surfaces with single-use towels.

Caring for and cleaning smooth surfaces

All smooth surfaces can be cleaned hygienically with water and a mild, liquid cleaning agent that is kind to the skin.

- i** Aggressive and scouring cleaning agents can damage the surface. Only use mild, liquid cleaning agents that are kind to the skin. The Geberit AquaClean cleaning set (art. no. 242.547.00.1) includes a ready-made cleaning agent that is optimal for cleaning all Geberit AquaClean surfaces.

Cleaning the flushing area of the WC ceramic appliance

- 1** Spray the WC ceramic appliance with Geberit AquaClean cleaning agent and allow the cleaning agent a few minutes to take effect.
- 2** Afterwards, rinse the WC ceramic appliance with water.
- 3** Remove stubborn stains with a toilet brush.

Cleaning the WC seat ring

The WC seat ring can be removed easily for simple cleaning.

- i** Be careful not to scratch the surface of the WC seat. Always place the components on a soft, non-scratching underlay.

- 1** Place the WC seat ring in the vertical position.

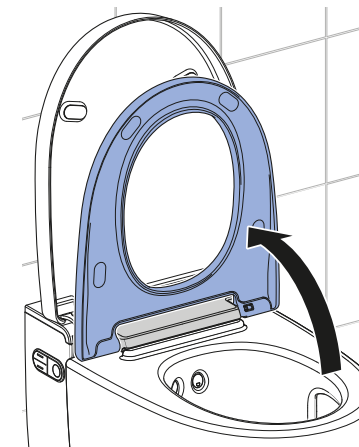

- 2** Slide the release button to the right and lift the WC seat ring out of the right-hand bracket.

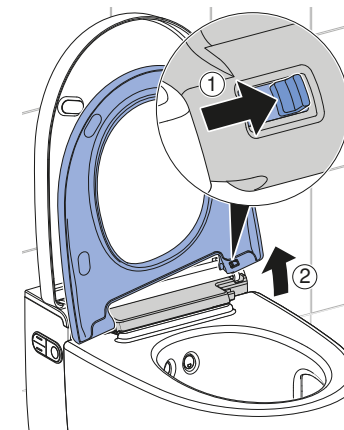

- 3** Slide the WC seat ring out of the left-hand hinge.

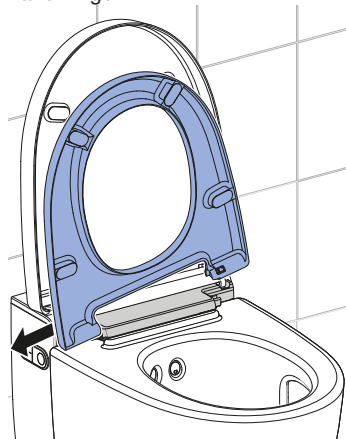

✓ The WC seat ring is removed and can be cleaned.

- 4** Spray the surfaces with Geberit AquaClean cleaning agent.
- 5** Wipe the surfaces with a soft, lint-free, damp cloth.
- 6** Then dry the surfaces with a soft, lint-free cloth.
- 7** After cleaning is complete, re-assemble the device in reverse order of disassembly.

Cleaning the WC lid and housing

i Be careful not to scratch the surface of the WC seat. Always place the components on a soft, non-scratching underlay.

- 1** Open the design cover.

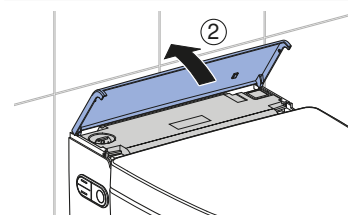
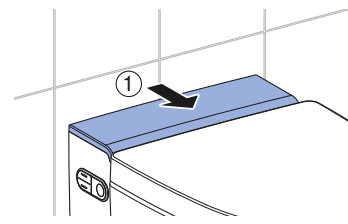

- 2** Open the WC lid.

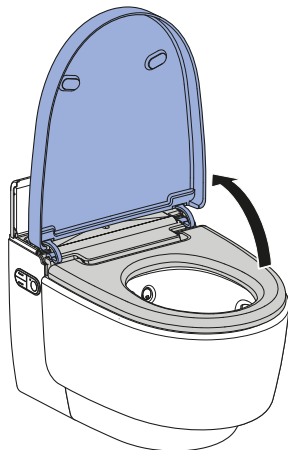

- 3** Lift the WC lid vertically out of its position.

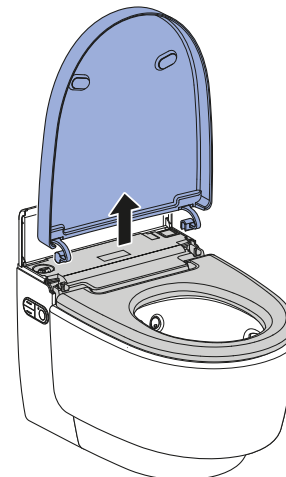

- 4** Spray the surfaces with Geberit AquaClean cleaning agent. Wipe the surfaces with a soft, lint-free, damp cloth.
- 5** Then dry the surfaces with a soft, lint-free cloth.
- 6** After cleaning is complete, re-assemble the device in reverse order of disassembly.

Cleaning the dryer arm and spray nozzle

i

- For cleaning, use a soft, lint-free cloth.
- Geberit AquaClean cleaning agent is particularly suitable for all surfaces of the device.

- 1** Open the WC lid.
- 2** Place the WC seat ring in the vertical position.
- 3** Press the <up> button and the <Shower> button at the same time.

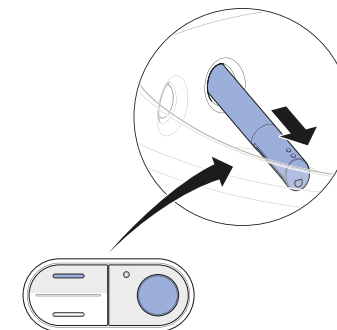

✓ The spray arm extends fully.

- 4** Twist the spray arm in any direction and remove it.

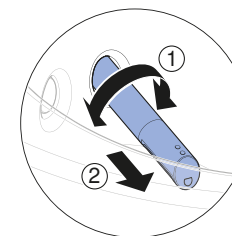

5 Pull out the spray nozzle for cleaning and descaling.

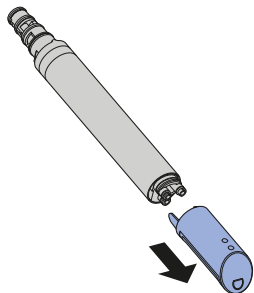

6 Replace the spray nozzle if it can no longer be completely cleaned and descaled.

7 Spray the spray arm with Geberit AquaClean cleaning agent. Then rinse the spray arm with water.

8 Dry both parts carefully before re-assembling and re-fitting the spray arm.

9 Press the <Shower> button to extend the dryer arm.

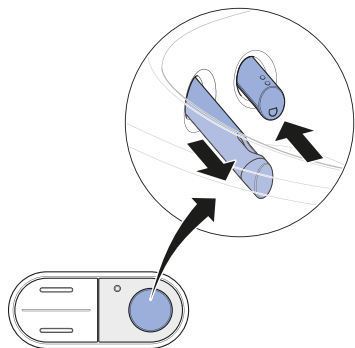

✓ The spray arm retracts and the dryer arm extends.

10 Unlock the dryer arm by turning it 90° to the left. Pull the dryer arm out.

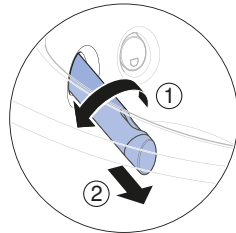

11 Press the unlock button on the rear side of the dryer arm and pull out the dryer nozzle.

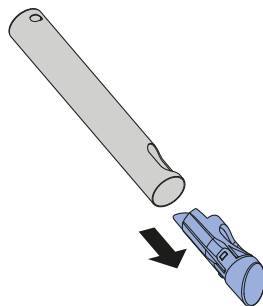

12 Clean the dryer arm and dryer nozzle. Dry both parts carefully before re-assembling the dryer arm.

13 Replace the dryer nozzle if it can no longer be completely cleaned.

14 Press the <Shower> button on the lateral control panel.

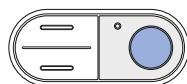

✓ The dryer arm retracts completely.

Result

✓ The cleaning procedure is now complete.

Descaling the device

Information on descaling:

- during the descaling procedure, you can continue to use the device without the shower toilet functions
- the descaling procedure lasts up to 60 minutes. During this time, the LED lights up orange and you can call up the descaling status via the display. Once the orange status LED switches off, the spray functionality is once again ready for operation

ATTENTION

Aggressive descaling agents

Inappropriate descaling agents can damage the device.

- ▶ Only use Geberit AquaClean descaling agent for descaling.

i The descaling procedure should not be cancelled after filling the descaling agent because it would otherwise be flushed away unused. The display shows [Device is flushing...].

Prerequisite

- The status LED on the lateral control panel flashes blue-red.
- At the touch of a button, the display on the rear of the remote control shows [Descalce device now] or [Descalce device now, device blocked].

1 Open the design cover.

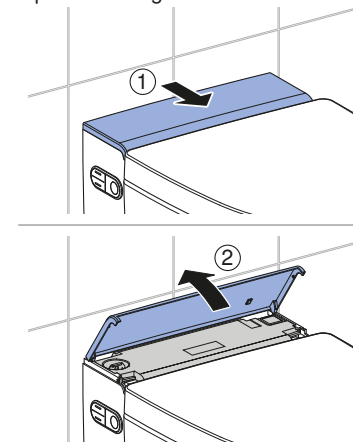

2 Remove the plug.

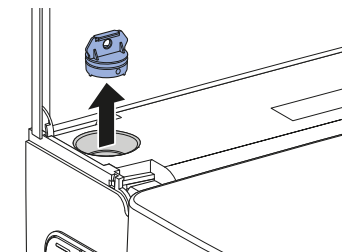

3 Launch the [Care and maintenance] main menu using the buttons on the rear of the remote control.

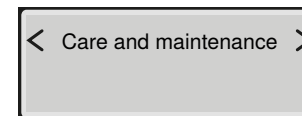

4 Use the <down> arrow key to select the [Descalce device now?] menu item.

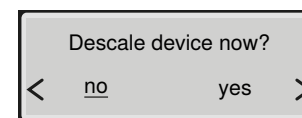

- 5** Use the arrow keys to select <yes>.
 ✓ The display shows

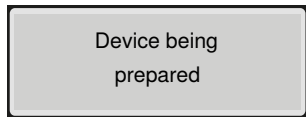

- 6** Wait until the device is ready for descaling.
 ✓ The display shows

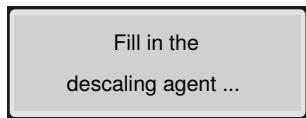

- 7** Pour a bottle (125 ml) of Geberit AquaClean descaling agent into the filling opening.

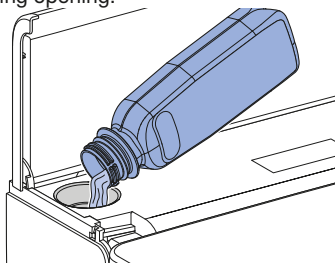

- 8** Re-insert the plug.

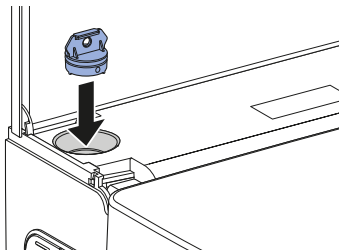

- 9** Remove splashes of descaling agent immediately with a damp cloth.

- 10** Close the design cover.

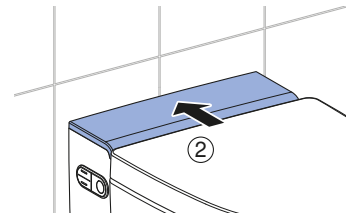
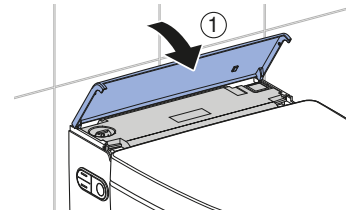

- 11** Use the arrow key to start the descaling procedure.

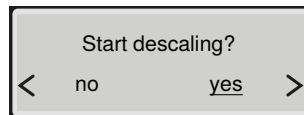

- ✓ A status message appears on the display which shows the duration of the descaling procedure.

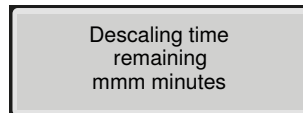

- ✓ The status LED on the lateral control panel lights up orange until the descaling procedure is complete.

Device descaling message

During installation, the device was configured for the local water hardness in accordance with the following table. This adaptation prevents unnecessary descaling procedures and helps protect the environment. Nevertheless, regular descaling of the device is required.

Area	°fH	°dH	°eH
soft	≤ 15	≤ 8	≤ 11
medium	15–25	8–14	11–18
hard	> 25	> 14	> 18

The following table helps you to identify descaling messages and to carry out the necessary fault clearance for each message.

Cause	Message	Fault clearance
Regular descaling: at least once a year	<ul style="list-style-type: none"> The status LED on the lateral control panel. The display shows [Descal device now]. 	<ul style="list-style-type: none"> ▶ Perform descaling. → See "Descaling the device", page 37.
Locked device: multiple rejected descaling requests	<ul style="list-style-type: none"> The status LED on the lateral control panel. The display shows [Descal device now, device locked]. 	<p>Prerequisite</p> <ul style="list-style-type: none"> – A shower procedure is no longer possible without descaling. ▶ Perform descaling. → See "Descaling the device", page 37.

NOTES
